

Installation

SUNNECT

DIGITAL DEADBOLT LOCK

AP501 ADVANCED PROTECTION

Note: Sunnect makes no commitments regarding the accuracy of translation into languages other than English.

Exploded View

- | | | |
|---|---------------------------|----------------------------|
| A. BATTERY COMPARTMENT SCREW HOLE COVER | G. RIGHT SCREW HOLE COVER | M. STRIKE PLATE SCREWS (2) |
| B. BATTERY COVER | H. MOUNTING SCREWS (3) | N. STRIKE PLATE |
| C. INTERIOR ATTACHMENT SCREWS (4) | I. MOUNTING BRACKET (3) | O. STRIKE LINING BOX |
| D. INTERIOR UNIT | J. EXTERIOR UNIT | P. REINFORCER SCREWS (2) |
| E. AA BATTERIES (4) | K. DEADBOLT LATCH | Q. STRIKE FRAME REINFORCER |
| F. LEFT SCREW HOLE COVER | L. FACE PLATE SCREWS (2) | |

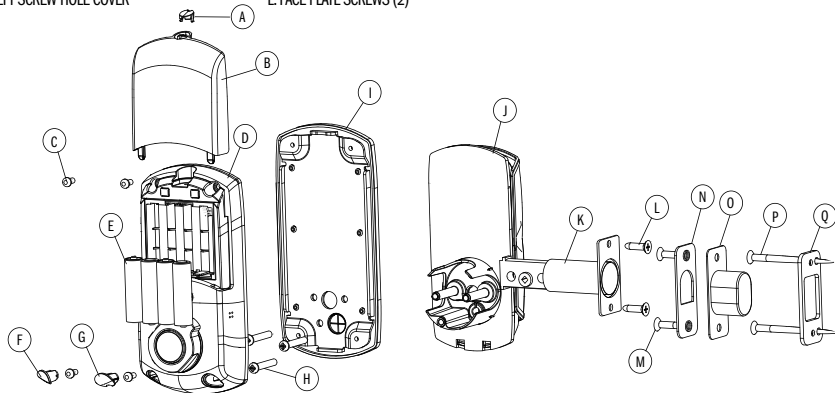

1 Door Preparation

Most residential doors are already prepared with the standard holes according to the standard specifications. If your door is not, use the drilling template included with the lock to drill required holes.

- A. The crossbore (facebore) hole should be 2 1/8 inches in diameter
- B. The edgebore hole should be 1 inch in diameter.
- C. The backset (distance between the edge of the door to the center of the crossbore hole) can be either 2 3/8 inches or 2 3/4 inches long.
- D. The Deadbolt Latch included in AP501 is adjustable so that it fits both backset distances.
- E. The faceplate should be 1 inch wide and 2 1/4 inches high.

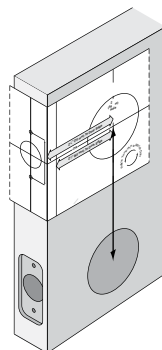

2 Adjusting the Deadbolt Latch

To adjust the length of the deadbolt latch, press the button on the bottom of the deadbolt latch and pull or push the tail-end accordingly.

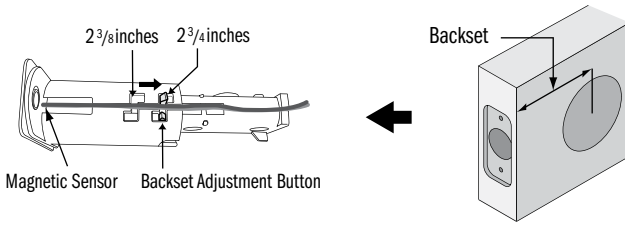

3 Install the Deadbolt Latch

- Make sure the deadbolt latch is retracted (unlocked).
- Keeping the magnetic sensor cable underneath, insert the deadbolt latch through the edgebore. It is important to make sure the deadbolt latch is inserted right-side up. Make sure the cable is clearly out of the edgebore hole before fastening the faceplate so that it is not pinched. (Figures 3-1 and 3-2)
- Fasten the faceplate with the face plate screws. (Figure 3-2)

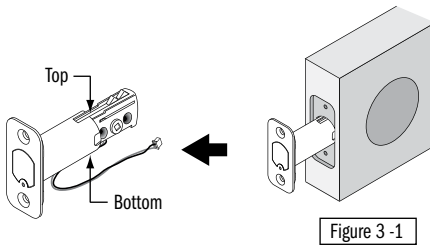

Figure 3-1

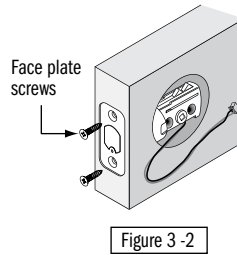
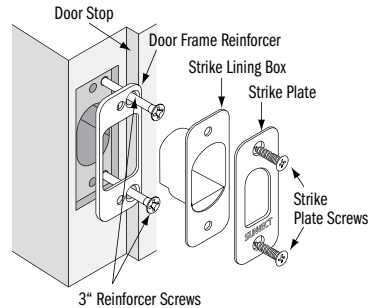

Figure 3-2

4 Install the 3-Part Strike Assembly

- First install the door frame reinforcer using the 3-inch screws. Make sure the screw holes are on the side nearest the doorstop. It may help to pre-drill two pilot holes for the reinforcer screws, 3/16" wide and 3" deep, and two pilot holes for the strike plate screws, 3/16" wide.
- Install the strike lining box by inserting the box through the door frame reinforcer. No screws are required.
- Install the strike plate over the strike lining box. Use two 3/4" screws.



Note

Make sure the distance between the strike plate and the face plate of the Deadbolt Latch, when the door is closed, is no more than 3/16" long. If the distance is greater than 3/16", then the Auto Lock sensor may not function correctly.

5 Install the Exterior Unit

- A. Place the exterior unit on the exterior side of the door.
- B. Pass the main cable of the exterior unit under the deadbolt.
- C. Insert the two mounting shafts of the exterior unit through the two mounting holes in the deadbolt latch.

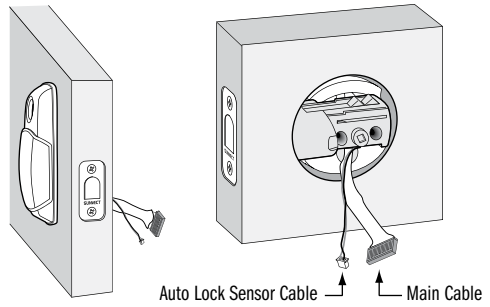

6 Install the Interior Mounting Plate

- A. Insert the main cable and the auto lock sensor cable through the cable hole located at the bottom of the interior mounting plate.
- B. Place the interior mounting plate against the interior side of the door while making sure the mounting shafts are aligned in the corresponding holes of the mounting plate.
- C. Install the interior mounting plate against the exterior unit using the 3 mounting screws in the mounting shafts. Before tightening the screws, it is important to make sure the exterior unit and the interior unit are both aligned parallel to the door edge.

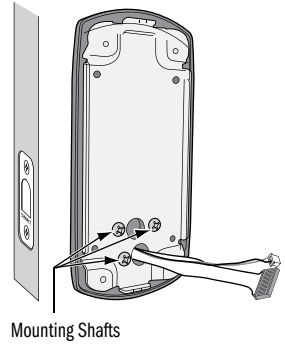

There are two sets of mounting screws of different lengths included in your door lock package: 1" (Short) and 1 2/5" (Long). If your door is 2 inches thick (the maximum door thickness supported), use the longer set of 1 2/5" mounting screws. Otherwise, use the shorter set of 1" screws.

7 Connect the Cables to the Circuit Board

- A. Connect the main cable and the auto lock sensor cable to their corresponding connector receptacles on the circuit board.
- B. Hook both of the cables through the cable hook located at the bottom of the interior unit. It is important to hook these cables to make sure the cables are not pinched during installation.

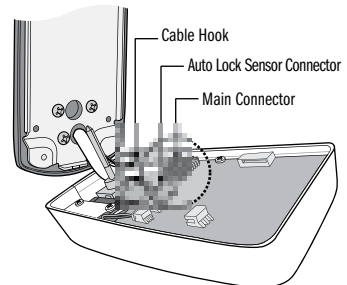

8 Install the Interior Unit

- A. Make sure the deadbolt latch is retracted (unlocked).
- B. On a left-handed door, make sure the Manual Override thumbturn is pointing to the right as in figure 8-1. On a right-handed door, make sure the Manual Override thumbturn is pointing to the left as in figure 8-2. The simple rule is this: the Manual Override thumbturn should be pointing away from the strike plate.



Figure 8-1



Figure 8-2

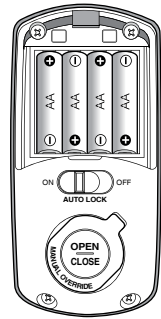

Figure 8-3

- C. Tighten the four screws as shown in Figure 8-3.
- D. Insert four AA batteries as shown in Figure 8-3.
- E. Test the installation by turning the Manual Override thumbturn several times and verifying that the deadbolt latch extends and retracts as expected. Repeat the same test with the Open/Close button.

9 Post-Installation Checklist

- A. Change the passcode after placing the 4 AA batteries. (Factory-set initial passcode is '1234.')
- B. Set the Left/Right Handing and Test.
- C. With the door open, confirm the new passcode by testing lock/unlock operations.
- D. Test the OPEN/CLOSE button on the interior body for proper operation.
If the door lock seems to lock when it should unlock, and vice versa, the handing is incorrect.
- E. Check the Deadbolt Latch for proper alignment by closing the door.
- F. Register one or more Tag Keys and test their operation.
- G. Confirm the Auto Lock mode setting and its operation.



Note

Run the above tests 2 to 3 more times. If all features function correctly each time, then the door lock is ready for you to use.

10 Install the Battery Compartment Cover and Screw Covers

- A. Place the battery compartment cover in the battery compartment and tighten the screw, making sure you do not overtighten it.
- B. Plug each screw hole with the screw covers. Make sure the screw covers are aligned properly. Please note that the left and right screw covers are different and you should use the correct cover for each screw.

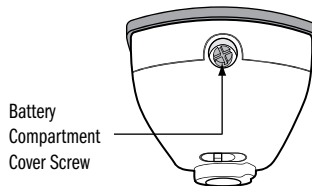

Battery Compartment Screw Hole Cover

